

REVISIONS			
REV.	DESCRIPTION	DATE	APPROVED
C	REVISED PER ECO #5788	10/6/99	J.A.
D	REVISED AND REDRAWN PER ECO #9970	11/04/10	K.R./S.L.

Nominal Coil Voltage	Part Number
12 Vdc	401-6208
15 Vdc	401-6908
20 Vdc	401-6708
24 Vdc	401-6808
28 Vdc	401-6308

REVISIONS	D	D	D			
SHEET NO.	1	2	3			
APPROVALS			DATE			
DRAWN SARA LEE			11/04/10			
ENGINEERING G. NICKLAUS			11/04/10			
QUALITY G. WAKEFIELD			11/04/10			
MANUFACTURING JAMES LEE			11/04/10			



DowKey®
Microwave
CORPORATION

4822 McGrath Street
Ventura, CA. 93003-5641
PH: (805) 650-0260
FAX: (805) 650-1734

A **DOVER** TECHNOLOGIES COMPANY

SWITCH, SPDT, FAILSAFE,
SMA-FEMALE CONNECTORS,
SUPPRESSION DIODE

CODE IDENT. NO. 00471	DWG. NO. 401-6X08
--------------------------	----------------------

SCALE NONE	FINAL ASSY:	SHEET 1 OF 3
------------	-------------	--------------

OUTLINE DRAWING:

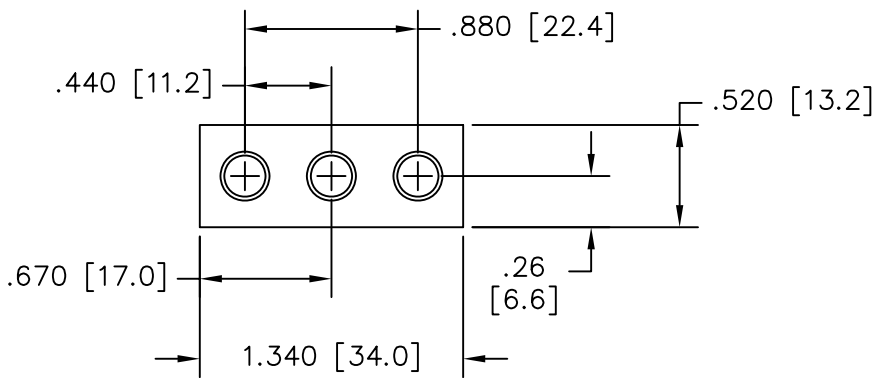
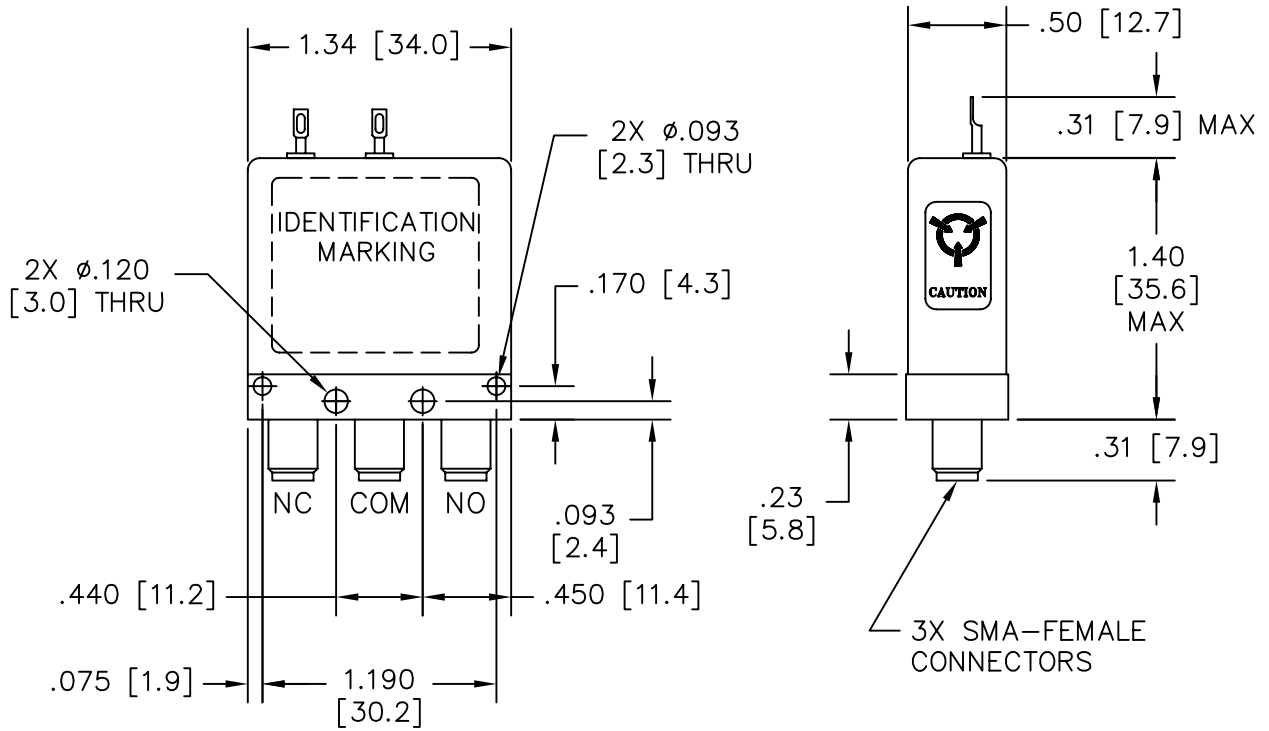
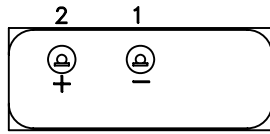

[] MILLIMETERS

UNLESS OTHERWISE SPECIFIED TOLERANCES ARE:
 .XXX ±.010 ANGLES: ±3°
 .XX ±.030

CODE IDENT. NO.
 00471

DWG. NO.
 401-6X08

REV.
 D

SCALE NONE

SHEET 2 OF 3

SPECIFICATIONS:

1. RF CHARACTERISTICS:

1.1 FREQUENCY (GHz):	DC-1	1-4	4-8	8-12	12-18
1.2 VSWR (RATIO MAX):	1.10:1	1.15:1	1.20:1	1.30:1	1.35:1
1.3 INSERTION LOSS (dB MAX):	0.10	0.15	0.20	0.30	0.35
1.4 ISOLATION (dB MIN):	85	80	70	65	60
1.5 RF POWER (WATTS CW MAX):	200	150	125	75	60

2. ACTUATION DATA:

2.1	NOMINAL VOLTAGE	OPERATING VOLTAGE	CURRENT (TYP)
			@ NOMINAL VOLTAGE & 25°C
	12	11-14	185mA
	15	13-17	160mA
	20	17-23	140mA
	24	20-28	120mA
	28	24-32	90mA

2.2 SWITCHING TIME:	15ms MAX
2.3 OPERATING MODE:	FAILSAFE

3. MECHANICAL:

3.1 RF CONTACTS:	BREAK BEFORE MAKE
3.2 WEIGHT:	1.3oz. (37g.) NOMINAL
3.3 DESIGN LIFE:	1,000,000 CYCLES MIN

4. ENVIRONMENTAL:

4.1 OPERATING TEMPERATURE:	-25°C TO +65°C
4.2 STORAGE TEMPERATURE:	-55°C TO +85°C
4.3 SEAL:	SAND AND DUST

SCHEMATIC:

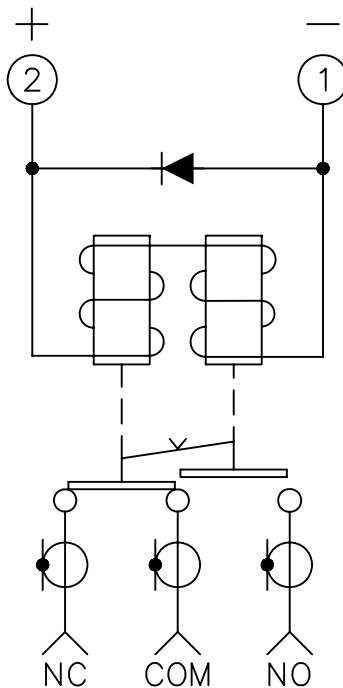

CODE IDENT. NO. 00471	DWG. NO. 401-6X08	REV. D
SCALE NONE	SHEET 3 OF 3	